

40+
kmph

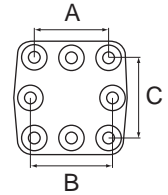

Bolt-On Ball & Spoon Hitches to ISO 24347



Heavy Duty - Up to 4.0 Ton Vertical Load

Max Speed (kph)	Up to 40 kph	Over 40 kph	Up to 40 kph	Over 40 kph	Up to 40 kph	Over 40 kph	Up to 40 kph	Over 40 kph	Up to 40 kph	Over 40 kph	Up to 40 kph	Over 40 kph
Max Vertical Load (ton)	4.5		4.0		3.5		3.0		2.5		2.0	
Max Towing Capacity (ton)	31.4	30.0	35.6	32.4	39.8	34.9	440	37.4	47.9	39.9	51.4	42.4
d-value (kN)	103.9	102.4	108.3	105.0	111.9	107.6	115.1	109.9	117.6	112	119.7	113.9

A	B	C	DESCRIPTION	PART NUMBER
145	145 - 160	145	Bolt-On ball and hitch spoon	8003310

10411



10410

Weld-On Fitting Plates to suit

HEIGHT	WIDTH	THICKNESS	TO SUIT	PART NUMBER
200	200	30	8003310	10410
345	200	30	8003310	10411

Bolts & Washers to suit Hitch / Fitting Plate

• 8 Bolts & washers required per hitch / fitting plate



DESCRIPTION	TO SUIT	PART NUMBER
M20 x 60 Allen head bolt - 12.9 strength	10409 / 10410 / 10411	M2060912129B
M20 Spring washer	10409 / 10410 / 10411	M20DIN127B
M20 Flat washer	10409 / 10410 / 10411	M20DIN125A