

McHUGH

C O M P O N E N T S



LED Lighting

2010

**LED Rear Lamp (1 Chamber 3 Function)**

Dimensions: 95 x 95 x 28mm

E Approved

VOLT	FUNCTION			PART NUMBER
	Stop & Tail	Direction	Reflector	
12V	•	•	No	LA93AR12
24V	•	•	No	LA93AR24

**LED Rear Lamp with Reflector (1 Chamber 3 Function)**

Dimensions: 165 x 100 x 32mm

VOLT	FUNCTION			PART NUMBER
	Stop & Tail	Direction	Reflector	
12/24V	•	•	1	LA215AR

**LED Rear Lamp with Reflector (2 Chamber 3 Function)**

Supplied with 4.5 metre cable

Dimensions: 175 x 95 x 33mm

E Approved

VOLT	FUNCTION			PART NUMBER
	Stop & Tail	Direction	Reflector	
12V	•	•	No	LA20612
24V	•	•	No	LA20624

**LED Rear Lamp with Reflector (2 Chamber 3 Function)**

Supplied with 2 metre cable

Dimensions: 215 x 100 x 32

VOLT	FUNCTION			PART NUMBER
	Stop & Tail	Direction	Reflector	
12V	•	•	1	LA202N2M2W
12/24V	•	•	1	LA21224N

**LED Rear Lamp (3 Chamber 3 Function)**

Supplied with 2m cable

Dimensions: 255 x 95 x 32mm

E Approved

VOLT	FUNCTION			PART NUMBER
	Stop & Tail	Direction	Reflector	
12/24V	•	•	No	LA210ARR

**LED Rear Lamp (3 Chamber 3 Function)**

Dimensions: 316 x 116 x 35mm

E Approved

VOLT	FUNCTION			PART NUMBER
	Stop & Tail	Direction	Reflector	
10-30V	•	•	No	LA3081030V

**LED Rear Lamp with Reflectors (3 Chamber 4 Function)**

Dimensions: 408 x 100 x 32mm

VOLT	FUNCTION				PART NUMBER
	Stop & Tail	Direction	Reverse	Reflector	
12/24V	•	•	•	2	LA217ARW

**LED Rear Lamp (3 Chamber 3 Function)**

Supplied with 2m wiring loom with plugs and sockets for easy installation

Dimensions: 415 x 146 x 32mm,

VOLT	FUNCTION			PART NUMBER
	Stop & Tail	Direction	Reflector	
12/24V	•	•	No	LA209ARR

**LED Number Plate Lamp**

DESCRIPTION	PART NUMBER
LED number plate light	LA300



Rear View

LED Rear (Hamburger) Lamp with Bowl Base

Diameter 140mm, Depth 82mm c/w 2 metre cable

Approved

VOLT	FUNCTION			PART NUMBER
	Stop & Tail	Direction	Reflector	
12V	•	•	Built in	LA16812
24V	•	•	Built in	LA16824

Rear View



NEW Type LED Rear Lamp with Bowl Base

- Super Bright SMD PLCC LED with **Exclusive Patent**
- Meets ECE, EEC, EMC & ROHS
- E Approved for road use
- Competitively Priced
- Supplied c/w Bowl and Fixing Screws
- Multivolt 9V - 33V
- Low Power Consumption
- Convenient Spade Connectors
- 3 Metre Harness available - LA6002H3

3 Function - Stop & Tail / Direction

Approved

VOLT	FUNCTION / WATTAGE				PART NUMBER
	Stop & Tail	Direction	Reverse	Fog	
9-33V	3W / 0.5W	3W	-	-	LA6002AR

1 Function - Direction

Approved

VOLT	FUNCTION / WATTAGE				PART NUMBER
	Stop & Tail	Direction	Reverse	Fog	
9-33V	-	3W	-	-	LA6002A

2 Function - Stop & Tail

Approved

VOLT	FUNCTION / WATTAGE				PART NUMBER
	Stop & Tail	Direction	Reverse	Fog	
9-33V	3W / 0.5W	-	-	-	LA6002R

1 Function - Reverse

Approved

VOLT	FUNCTION / WATTAGE				PART NUMBER
	Stop & Tail	Direction	Reverse	Fog	
9-33V	-	-	3W	-	LA6002W

1 Function - Fog

Approved

VOLT	FUNCTION / WATTAGE				PART NUMBER
	Stop & Tail	Direction	Reverse	Fog	
9-33V	-	-	-	4W	LA6002F

Optional Harness

DESCRIPTION	PART NUMBER
3 meter wire harness to suit New type LED rear lamps	LA6002H3



Marker Lamps - Type LA200



LED Marker Lamp with Bracket

Width 110mm, Height 75mm (Including Bracket), Depth 24mm

Ⓔ Approved

DESCRIPTION	COLOUR	PART NUMBER
12V LED side marker lamp	AMBER	LA20012KA
24V LED side marker lamp	AMBER	LA20024KA

LED Marker Lamp (Surface Mounted)

Width 110mm, Height 51mm, Depth 24mm

Ⓔ Approved



DESCRIPTION	COLOUR	PART NUMBER
12V LED marker lamp	AMBER	LA20012A
10-30V LED marker lamp	AMBER	LA2001030A

Ⓔ Approved



DESCRIPTION	COLOUR	PART NUMBER
12V LED marker lamp	RED	LA20012R
24V LED marker lamp	RED	LA20024R
10-30V LED marker lamp	RED	LA2001030R

Ⓔ Approved



DESCRIPTION	COLOUR	PART NUMBER
12V LED marker lamp	WHITE	LA20012W
24V LED marker lamp	WHITE	LA20024W
10-30V LED marker lamp	WHITE	LA2001030W



Bracket to suit Type LA200 Marker Lamps

DESCRIPTION	PART NUMBER
Bracket to suit LA200 marker lamps	LA200B

Marker Lamps - Type LA87



LED Marker Lamp (10-30V)

Width 73.5mm, Height 37.5mm, Depth 32mm

Ⓔ Approved

DESCRIPTION	COLOUR	PART NUMBER
10-30V LED marker lamp	AMBER	LA871030A

Ⓔ Approved



DESCRIPTION	COLOUR	PART NUMBER
10-30V LED marker lamp	RED	LA871030R

Ⓔ Approved



DESCRIPTION	COLOUR	PART NUMBER
10-30V LED marker lamp	White	LA871030W



LED Marker Lamp Flush Mounted

Width 104mm, Height 36mm

Ⓔ Approved

DESCRIPTION	COLOUR	PART NUMBER
12V LED marker lamp	AMBER	1301570112
24V LED marker lamp	AMBER	1301570100

Ⓔ Approved

DESCRIPTION	COLOUR	PART NUMBER
12V LED marker lamp	RED	1301570212
24V LED marker lamp	RED	1301570200

Ⓔ Approved

DESCRIPTION	COLOUR	PART NUMBER
12V LED marker lamp	WHITE	1301570012
24V LED marker lamp	WHITE	1301570000



LED Marker Lamp Surface Mounted

Width 104mm, Height 36mm

Ⓔ Approved

DESCRIPTION	COLOUR	PART NUMBER
12V LED marker lamp	AMBER	131570305112
24V LED marker lamp	AMBER	131570305124

Ⓔ Approved

DESCRIPTION	COLOUR	PART NUMBER
12V LED marker lamp	RED	131570305212
24V LED marker lamp	RED	131570305224

Ⓔ Approved

DESCRIPTION	COLOUR	PART NUMBER
12V LED marker lamp	WHITE	131570305012
24V LED marker lamp	WHITE	131570305024



LED Wing Marker Lamp (Dual Voltage)

- Front, rear and side position lamp
- Colour: Red / Amber / White

Ⓔ Approved

DESCRIPTION	COLOUR			PART NUMBER
Dual voltage	RED	AMBER	WHITE	LA286

LED Stalk End Marker Lamp - Short (Dual Voltage)

- Front, rear and side position clearance lamp
- Red / Amber / White

Ⓔ Approved

DESCRIPTION	COLOUR			PART NUMBER
Dual voltage	RED	AMBER	WHITE	LA241LH
Dual voltage	RED	AMBER	WHITE	LA241RH

LED Stalk End Marker Lamp - Long (Dual Voltage)

- Front, rear and side position clearance lamp
- Red / Amber / White

Ⓔ Approved

DESCRIPTION	COLOUR			PART NUMBER
Dual voltage	RED	AMBER	WHITE	LA238LH
Dual voltage	RED	AMBER	WHITE	LA238RH

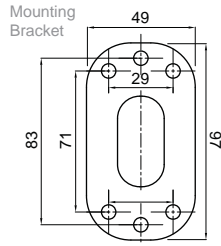

LED Wing Marker Lamp

Ⓔ Approved

- 10-30 Volt
- Front and Rear marker lamp

SIDE	COLOUR	PART NUMBER
LH & RH	RED	WHITE
		LA296

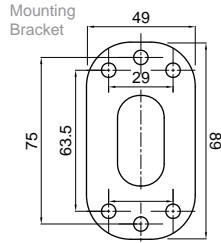

LED Stalk End Marker Lamp

Ⓔ Approved

- 10-30 Volt
- Stalk end marker lamp short

SIDE	COLOUR	PART NUMBER
LH	RED	WHITE
RH	RED	WHITE
		LA299LH
		LA299RH

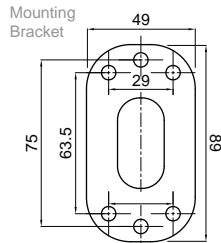

LED Stalk End Marker Lamp

Ⓔ Approved

- Stalk end marker lamp long

SIDE	COLOUR	PART NUMBER
LH	RED	WHITE
RH	RED	WHITE
		LA295LH
		LA295RH

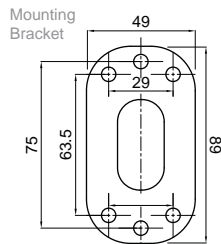

LED 90° Stalk End Marker Lamp

Ⓔ Approved

- 90° Stalk end marker lamp short

SIDE	COLOUR	PART NUMBER
LH	RED	WHITE
RH	RED	WHITE
		LA294LH
		LA294RH

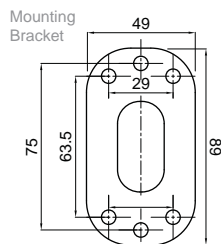

LED 90° Stalk End Marker Lamp

Ⓔ Approved

- 90° Stalk end marker lamp long

SIDE	COLOUR	PART NUMBER
LH	RED	WHITE
RH	RED	WHITE
		LA297LH
		LA297RH



LED Round Work Lamp

LED work lamp with Rubber body, dimensions 125 x 75mm

VOLT	POWER	LUMINOUS INTENSITY Lm	LIFE HOURS	PART NUMBER
12V	5.2W	546	10,000	LA105B12
24V	5.0W	546	10,000	LA105B24



LED Round Work Lamp (Dual Voltage)

Universal external fitting work lamp with aluminium body. Dimensions 116 x 135 x 43mm

Supplied with Dual fitting kit which allows a single bolt option on the bottom or a dual bolt option at the rear.

VOLT	POWER	LEDs	LUMINOUS INTENSITY Lm	LIFE HOURS	PART NUMBER
12 / 24V	18W	6 x 3W	1350	10,000	LA1111224



LED Square Work Lamp (Dual Voltage)

Universal external fitting work lamp with aluminium body. Dimensions 110 x 135 x 41mm

Supplied with Dual fitting kit which allows a single bolt option on the bottom or a dual bolt option at the rear.

VOLT	POWER	LEDs	LUMINOUS INTENSITY Lm	LIFE HOURS	PART NUMBER
12 / 24V	15W	5 x 3W	1050	10,000	LA2201224

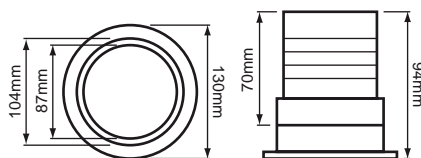

LED Emergency Warning Strobe Beacon (360°) Flat Base

Dimensions: Height 94mm, Width 130mm

DESCRIPTION	VOLTAGE	PART NUMBER
LED Beacon flat base	10-30V	LA55000A



LED Emergency Warning Strobe Beacon (360°) Single Bolt

Dimensions: Height 94mm, Width 130mm

DESCRIPTION	VOLTAGE	PART NUMBER
LED Beacon single bolt	10-30V	LA55100A



LED Emergency Warning Strobe Beacon (360°) Magnetic Base

Dimensions: Height 94mm, Width 130mm

DESCRIPTION	VOLTAGE	PART NUMBER
LED Beacon magnetic base	10-30V	LA55200A



LED High Power Strobe Lights

7 Function Flash Pattern, Length = 123mm, Width = 50.8mm, Depth = 31mm

DESCRIPTION	VOLTAGE	COLOUR	PART NUMBER
LED High power strobe light	10-30V	AMBER	LA14000VA
LED High power strobe light	10-30V	RED	LA14000VR

VigiLED

Suitable for Fleet, Cars, Delivery, Refuse Trucks, Utilities, Road Maintenance, Road Maintenance and Road Safety

Features

- Surface mount or bracket mount triple flash LED directional
- Dual voltage 12 / 24V (10.5-30Vdc)
- High brightness 100,000 hour rated LED
- Clear lens with coloured LEDs
- Ultra low power consumption
- Synchronised and alternate flash patterns available with multi beacons
- Integrated electronics - no need for separate power supply or control unit

Specifications

- Current Consumption at 12V: 120mA
- Current Consumption at 24V: 65mA
- Flash Rate: 75 Flashes per minute
- Triple Flash
- Ingress Protection Rating (Waterproof Rating): IP65
- Brightness: 12cd amber
(cd = effective candela in accordance with Blondel & Rey formula)

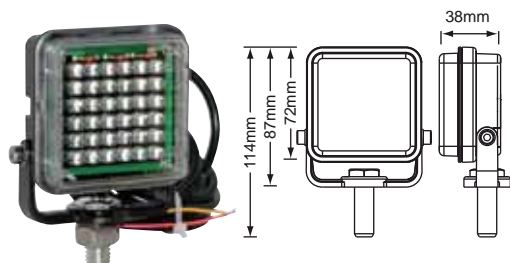

Directional LED Beacon (Dual Voltage)

DESCRIPTION	COLOUR	PART NUMBER
VigiLED beacon	AMBER	497022
VigiLED beacon	RED	497023
VigiLED beacon	BLUE	497024

Note: Blue and White available. Contact a member of our Sales Staff for further details.

LED Resistors

This may be required due to the low power consumption of LED lights which causes a faulty bulb warning to be displayed in the cab. The resistor increases the power consumption in the circuit.



DESCRIPTION	PART NUMBER
LED Resistors for 12V circuit	LA312
LED Resistors for 24V circuit	LA324

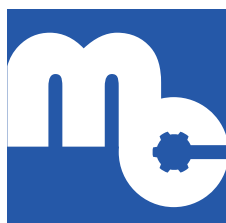

McHugh Components
89 Broomhill Road
Tallaght Industrial Estate
Tallaght
Dublin 24
Ireland

Telephone: (01) 413 7000
Telefax: (01) 414 5370
Email: info@mchc.ie
Website: www.mchc.ie