

Faster ANV / NV Series Poppet Type - ISO A

- Connection system: Pushing the male coupling
- Disconnection system: Pulling the male coupling
- Connectability: Without pressure
- Disconnection under pressure: In emergency only
- Shut-off system: Poppet valve
- Interchangeable: According to ISO 7241-1 part A standard
- Other thread types available on request



| FEMALE THREAD | BASE | FLOW RATE | MAX WORKING PRESSURE | MALE PART NUMBER | FEMALE PART NUMBER |
|---------------|------|-----------|----------------------|------------------|--------------------|
| 1/4" BSP | 04 | 9 lpm | 500 bar | ANV14GASM | ANV14GASF |
| 3/8" BSP | 06 | 30 lpm | 300 bar | ANV38GASM | ANV38GASF |
| 1/2" BSP | 08 | 75 lpm | 300 bar | NV12GASM | NV12GASF |
| 1/2" NPT | 08 | 75 lpm | 300 bar | NV12NPTM | NV12NPTF |
| M22x1.5 | 08 | 75 lpm | 300 bar | NV02215M | NV02215F |
| 3/4" BSP | 12 | 180 lpm | 300 bar | ANV34GASM | ANV34GASF |
| 1" BSP | 16 | 270 lpm | 250 bar | ANV1GASM | ANV1GASF |
| 1 1/4" BSP | 20 | 330 lpm | 250 bar | ANV114GASM | ANV114GASF |

Faster ANV / NV Series Poppet Type - ISO A - Stainless Steel

| FEMALE THREAD | BASE | FLOW RATE | MAX WORKING PRESSURE | MALE PART NUMBER | FEMALE PART NUMBER |
|---------------|------|-----------|----------------------|------------------|--------------------|
| 1/2" BSP | 08 | 75 lpm | 275 bar | NV12GASM2V | NV12GASF2V |

Faster ANV / NV Series Poppet Type - ISO A (Male Thread)

- Connection system: Pushing the male coupling
- Disconnection system: Pulling the male coupling
- Connectability: Without pressure
- Disconnection under pressure: In emergency only
- Shut-off system: Poppet valve
- Interchangeable: According to ISO 7241-1 part A standard
- Other thread types available on request

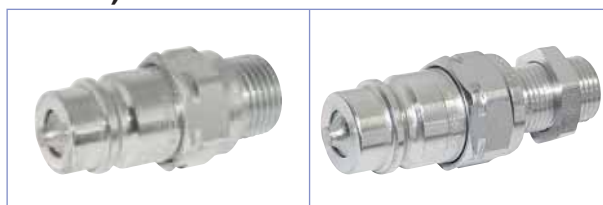

| MALE THREAD | BASE | FLOW RATE | MAX WORKING PRESSURE | MALE PART NUMBER | MALE BULKHEAD (25mm Thread Length) |
|-------------|------|-----------|----------------------|------------------|------------------------------------|
| 3/8" BSP | 08 | 75 lpm | 300 bar | CNV138GASM | - |
| 1/2" BSP | 08 | 75 lpm | 300 bar | CNV112GASM | - |
| M18x1.5 | 08 | 75 lpm | 300 bar | - | CNV71815M |
| M22x1.5 | 08 | 75 lpm | 300 bar | - | CNV72215M |
| M30x2.0 | 16 | 270 lpm | 220 bar | CNV163-302M | - |

Faster NS Series Ball Type ISO - A

- Connection system: Pull back the sleeve
- Disconnection system: Pulling back the sleeve
- Connectability: Without pressure
- Disconnection under pressure: Not allowed
- Shut-off system: Ball valve
- Interchangeable: According to ISO 7241-1 part A standard (1/2" size only)
- Other thread types available on request

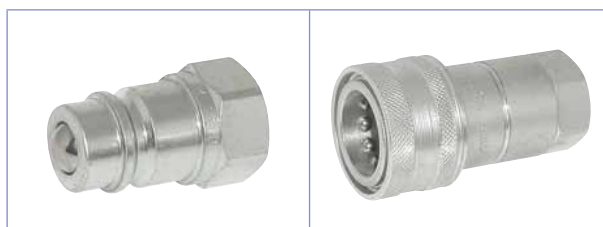

| FEMALE THREAD | BASE | FLOW RATE | MAX WORKING PRESSURE | MALE PART NUMBER | FEMALE PART NUMBER |
|---------------|------|-----------|----------------------|------------------|--------------------|
| 3/8" BSP | 06 | 30 lpm | 250 bar | NS38GASM | NS38GASF |
| 1/2" BSP | 08 | 50 lpm | 200 bar | NS12GASM | NS12GASF |